

MC 650S/12C / 625C/675LT/ 570S/540C/600LT Installation Diagram

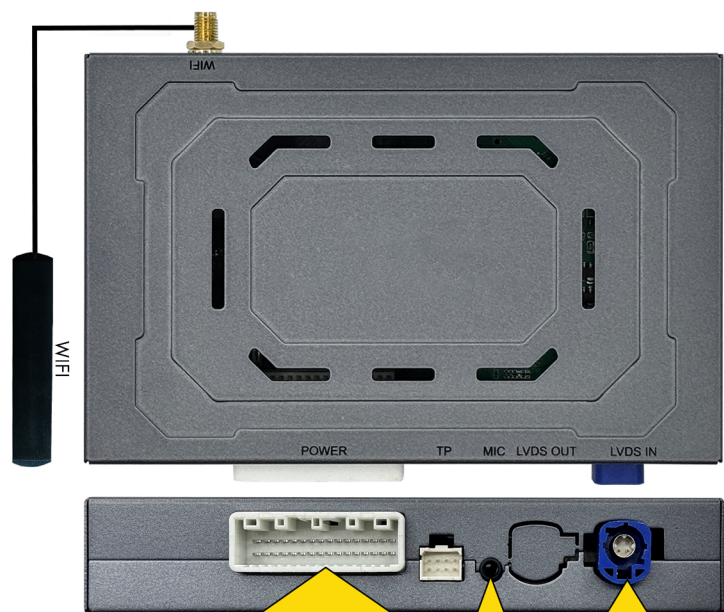

1 Long Press (Home)



360 ACC
REAR CAM 12V OUT
FRONT CAM 12V OUT
REVERSE 12V IN

FRONT CAM IN
REAR CAM IN
VIDEO IN

CONNECT THE OEM AUX

OEM plug

OEM plug

LVDSOUT
LVDS IN
OEM LVDS

DIP SETTING



Check DIP settings before installation.
Reconnect the white connector after DIP changes.

How to Connect Wireless Apple CarPlay

1, Long press switch button (different car with different switch button, check from installation diagram) to enter AutoSmartLink system main menu as below:



2, Then turn ON Wi-Fi from iPhone's settings, you will find option of "WiFi-AP-****", but DO NOT connect it, and DON'T connect any other network.

Turn ON Bluetooth, find and click "AutoSmartLink", then according below steps get wireless connection
(Note: If "AutoSmartLink" shows connected, but didn't go to carplay, then click Setup -> Bluetooth -> Paired device -> WiFi CarPlay then iPhone will show Use CarPlay request)

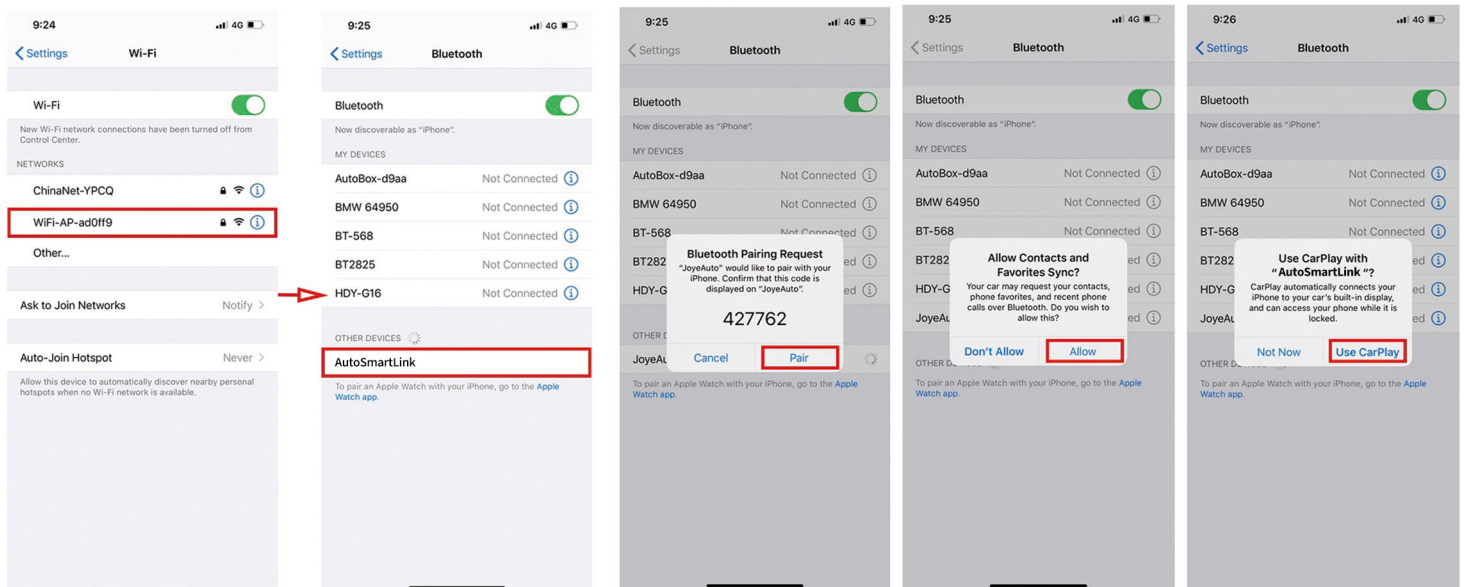

3, After 5 sec, it will enter CarPlay screen automatically, then enjoying...

