

# User Manual



## Tuning Solutions



## Features

Long Press specific button to switch to iManAuto system main menu as picture

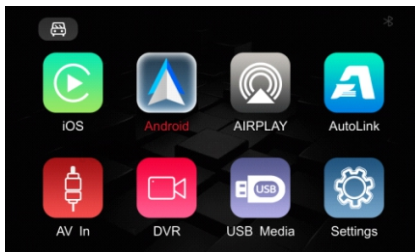

\*Wired/Wireless CarPlay

\*Wired/Wireless Android AUTO

\*Screen casting function(Apple, Android)

\*USB multimedia playback(support lossless audio, 720P video and picture playback)

\*Support original rear view,aftermarket rear view, (CVBS/AHD), front view(Support setting time delay) or DVR

\*Support the expansion of the addition of 360 panoramic view(CVBS/AHD)

\*Support audio EQ adjustment, music navigation volume adjustment separately

\*Support the original MIC(reserved for retrofitting MIC), support the call elimination echo automatic correction function.

\*Support the original car Bluetooth call function

\*Support AUX IN function and expandable digital TV

\*Support wired BaiDu Car Life(need factory setting to open, password(0301)

## Accessories



Power cable



LVDS cable



WIFI cable



MIC cable



AUX plug

## Connection method

**Wireless CarPlay connection for the first time as follows (manual method):**

Enter the wireless CarPlay settings and click on"Discover and connect devices"to bring up CX\_BT As shown below

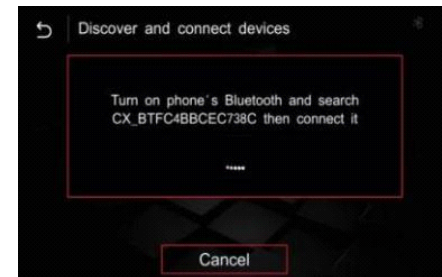
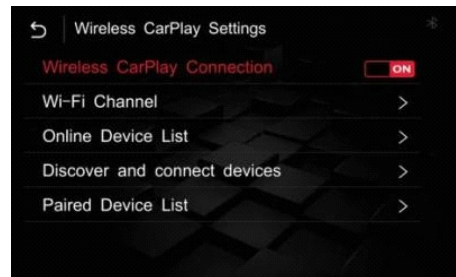

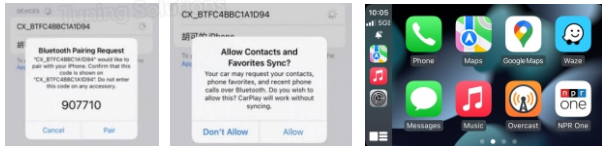

Turn on the Bluetooth function on your iPhone as shown above and search for the name CX\_BT..., click connect and pair, then click use carplay

When you enter the interface, the wireless CarPlay will be connected successfully.

Note: (When connecting for the first time, manually complete the Bluetooth pairing of your iPhone. When the WIFI on your iPhone is turned on, the wireless CarPlay connection can be completed). And then the next time you start the car, it will automatically connect.

\*Simple first-time wireless CarPlay connection method: First make a wired connection via USB, then enable wireless CarPlay on the phone according to the prompts, and the wireless connection will automatically connect after 15 seconds of unplugging the data cable.

### The first-time wireless CarPlay connection is as follows (manual method):

Enter the settings - the wireless Android Auto settings, click pairing and the CX-BT... will pop up, as shown in the picture

Connect CX\_BT...with Android phone Bluetooth receiver and search. After successful pairing, you will enter the AUTO interface as below:

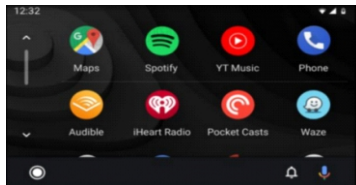
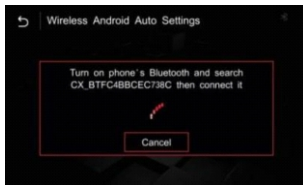
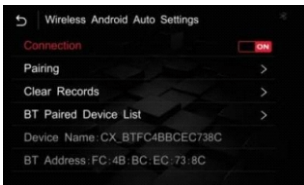

When you enter the interface, the wireless AUTO will be connected successfully.

\*Simple first-time wireless AUTO connection method: First make a wired connection via USB, then connect AUTO according to your phone's prompts, and the wireless AUTO will automatically connect after 15 seconds of unplugging the data cable.

## USB flash play

Insert the U disk will automatically jump to the USB interface, support audio, 720P video.

## System Settings

### Echo Settings:

\*Anti-echo processing method: If there is an echo in the call, you can do the echo elimination process as shown, and then confirm the call echo problem.

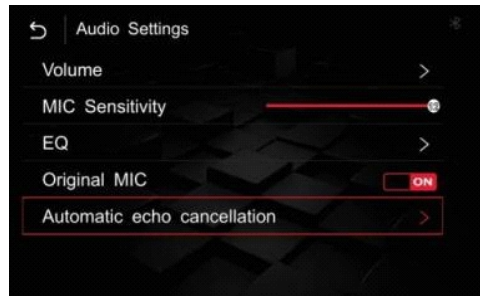

## Language setting:

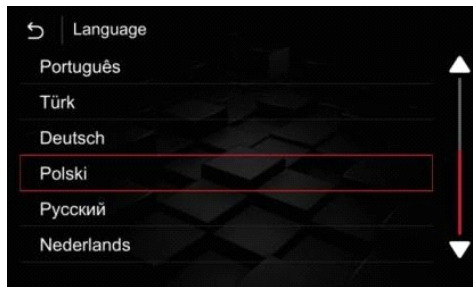

## Audio Settings:

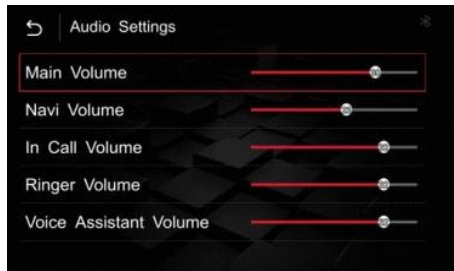
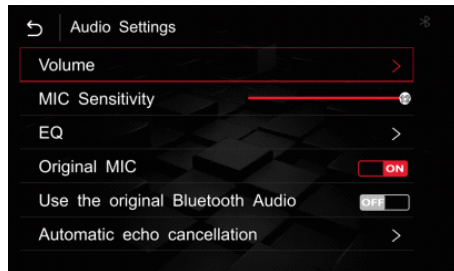

## Microphone Settings:

Original car Bluetooth phone mode: Original MIC---ON

Additional microphone mode: Original MIC---OFF

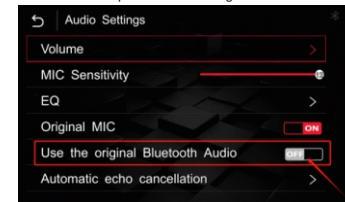

## Sound channel:

Using the original external sound aux:use the original bluetooth audio---OFF

Using the original Bluetooth audio:use the original bluetooth audio---ON(The phone needs to be connected to the original Bluetooth audio.)

Audio settings are commonly operated as shown, and default values are generally recommended.

## How to reset the system:(left and right driving)

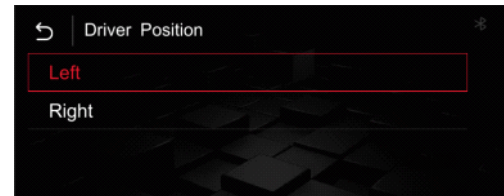
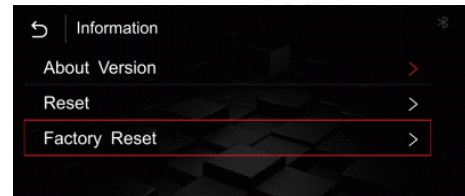



## Opel Installation and Usage Diagram

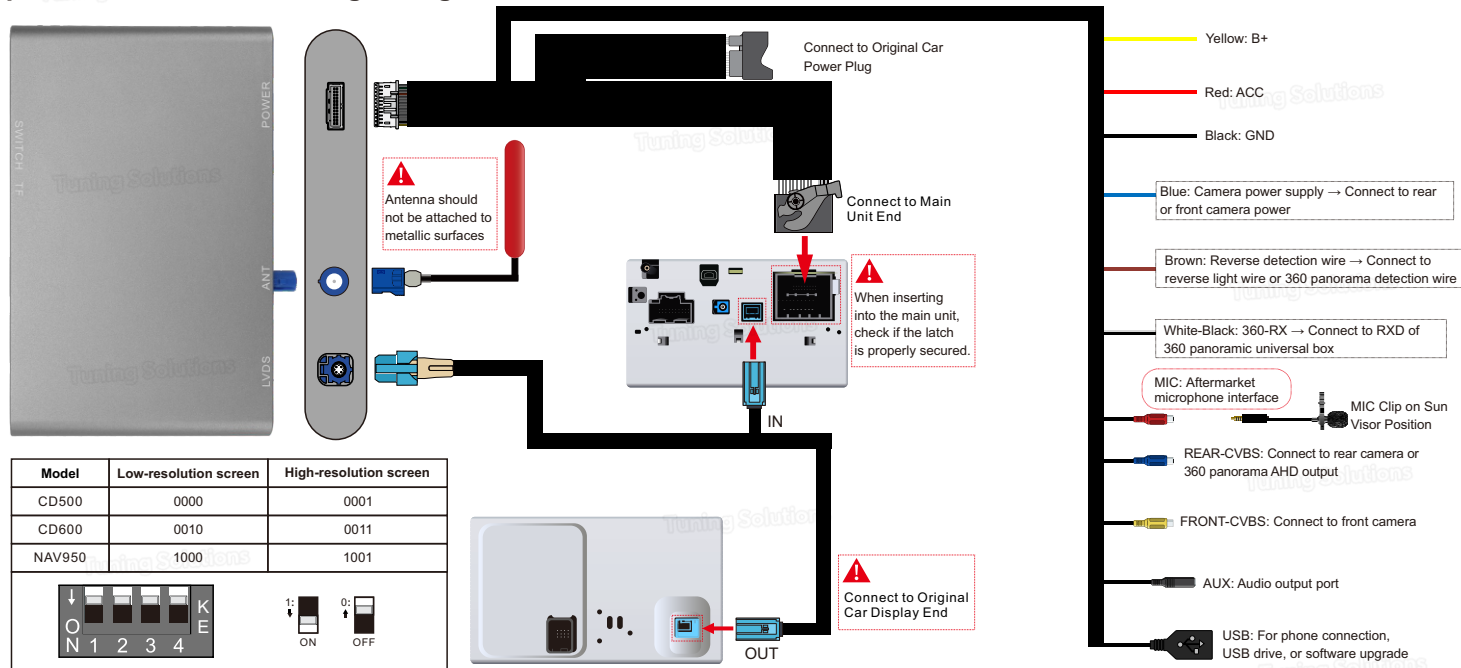

| Model  | Low-resolution screen | High-resolution screen |
|--------|-----------------------|------------------------|
| CD500  | 0000                  | 0001                   |
| CD600  | 0010                  | 0011                   |
| NAV950 | 1000                  | 1001                   |

|    |   |   |   |   |    |
|----|---|---|---|---|----|
| ON | 1 | 2 | 3 | 4 | KE |
|----|---|---|---|---|----|

|    |    |    |     |
|----|----|----|-----|
| 1: | ON | 0: | OFF |
|----|----|----|-----|

## Steering Wheel Button Functions



- ② Short press: Answer call  
Long press: Activate voice control (when not using original Bluetooth)
- ③ Short press: Hang up phone
- ④ Short press: Volume up/down
- ⑤ Short press: Previous/Next track  
Long press: Switch system

## Central Control Knob Instructions



- ① Long press: Switch system
- ② Rotate: Move cursor  
Short press: Confirm  
Long press: Confirm to activate voice control



Original Car AUX Port Location

## Important tips:

1. During installation, the AUX adapter needs to be plugged into the original vehicle's AUX port.
2. Before entering the installation system, switch the original car sound channel to the AUX channel.
3. When inserting the MIC plug, pay attention to whether it is inserted correctly to prevent the MIC from being ineffective due to reverse insertion

## Camera setting:

### Automatic transmission

- ① Select the rear camera in the camera setting
- ② Connect the blue wire(cam power)to the camera
- ③ Connect the trunk camera power wire together  
(connect these two red cables together)

### Manual transmission

- ① Select the 360 camera in the camera setting
  - ② Connect the brown wire(360 DET)
  - ③ Connect the trunk camera power wire to the reverse lamp 12V  
(some cars need to connect a rectifier)
- The original car does not reverse image should also be so connected like this.

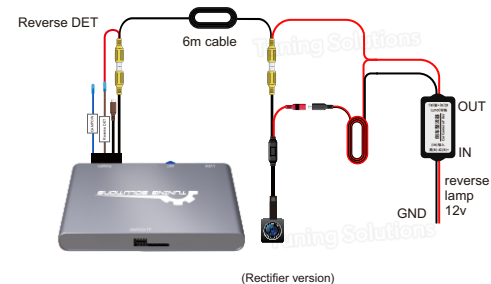
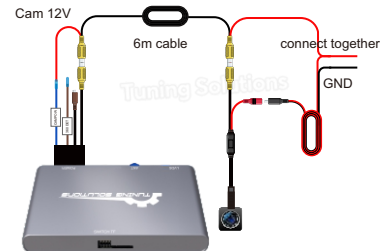

Original car with reversing camera:aftermarket camera/original camera---ON

Retrofitting a back-up camera:aftermarket camera/original camera---OFF

rear view settings as pictured above, if you add an AHD camera you need to enter the

AHD there to select the frame rate